



COUNTY OF SONOMA
PERMIT AND RESOURCE MANAGEMENT DEPARTMENT

2550 Ventura Avenue, Santa Rosa, CA 95403-2829
 (707) 565-1900 FAX (707) 565-1103

CERTIFICATION OF WATER YIELD IN WATER SCARCE AREAS

The Permit and Resource Management Department shall be notified 24 hours in advance of this test

Water Yield # _____

Well Permit # WEL08-0248

- I. Individual performing test: NICHOLAS BRASESCO
- II. Type of license/registration, number and expiration date: C61/D21, #903708, EXP 9/30/2009
- III. Location of well:
 Address: 1880 HWY 1, BODEGA BAY, CA A.P. #: 100-210-057
- IV. Type and model of test pump: 2 HP Jacuzzi Submersible
- V. Test pump setting depth: 180 Feet
- VI. Maximum reported yield for this pump type at this setting: 4.6 GPM
- VII. Type of discharge measurement method: Meter, Bucket, S. Watch
- VIII. Type and model of flow meter (or provide an accurate description of weir or orifice plate):
5/8" Sensus Flow Meter
- Geographic coordinates (Plane Coordinate Method or distance from fixed landmarks): N 38 Deg 20.434' W 123 Deg 02.692'
- IX. Estimated elevation of well head: 244 Feet
- X. Initial static water level (include measuring points such as top of casing, surface seal, access port): 58 Feet 7 Inches
 Measured from top of well casing. Top of casing is 1 foot 8 inches above grade.
- XI. Date & time of initial static water level measurement: Jul 19, 2009 8:30 a.m./p.m.
- A. Discharge Rate: 4.6 GPM
- B. Dynamic Water Level: 98'8"
- C. Specific Capacity: .0349
- D. Pump Test duration: 12 Hours 50 Minutes

XII. Immediately after the test take the following measurements:

- A. Dynamic water level: 98'8"
- B. Final discharge rate: 1.4 GPM

XIII. Post - Test Measurement:

- A. Dynamic water level: 98'8"
- B. Static water level: 60'3"
- C. Percentage of recovery of final static level: 95.84%

Testing performed by (signature): 

Date: 7-19-09 Company: Ray's Well Testing Phone Number: 707 823 3191

Approved _____ Denied _____ Specialist _____ Date _____

Well Pump Test Data Recordation

Address: 1880 HWY 1, BODEGA BAY, CA

Date	Time	Interval	SWL	GPM	Comments		
7/19/09	8:31am	1 Min	58'7"	4.6			
7/19/09	8:32am	1 Min	62'8"	4.6			
7/19/09	8:33am	1 Min	65'6"	4.5			
7/19/09	8:34am	1 Min	66'9"	4.4			
7/19/09	8:35am	1 Min	67'8"	4.4			
7/19/09	8:40am	5 Mins	75'7"	4.3			
7/19/09	8:45am	5 Mins	78'7"	4.2			
7/19/09	8:50am	5 Mins	82'0"	4.1			
7/19/09	8:55am	5 Mins	87'0"	4.0			
7/19/09	9:00am	5 Mins	90'3"	4.0			
7/19/09	9:05am	5 Mins	95'2"	4.0			
7/19/09	9:10am	5 Mins	98'2"	4.0			
7/19/09	9:15am	5 Mins	99'9"	4.0			
7/19/09	9:20am	5 Mins	98'8"	1.5	Flow Adjusted	Start	12 Hr Test
7/19/09	9:25am	5 Mins	98'8"	1.5			
7/19/09	9:30am	5 Mins	98'8"	1.5			
7/19/09	9:35am	5 Mins	98'8"	1.5			
7/19/09	9:55am	20 Mins	98'8"	1.5			
7/19/09	10:15am	20 Mins	98'8"	1.5			
7/19/09	10:35am	20 Mins	98'8"	1.5			
7/19/09	11:05am	30 Mins	98'8"	1.5			
7/19/09	11:35am	30 Mins	98'8"	1.5			
7/19/09	12:05pm	30 Mins	98'8"	1.5			
7/19/09	12:35pm	30 Mins	98'8"	1.5			
7/19/09	1:05pm	30 Mins	98'8"	1.5			
7/19/09	1:35pm	30 Mins	98'8"	1.5			
7/19/09	2:05pm	30 Mins	98'8"	1.5			
7/19/09	2:35pm	30 Mins	98'8"	1.5			
7/19/09	3:05pm	30 Mins	98'8"	1.5			
7/19/09	3:35pm	30 Mins	98'8"	1.5			
7/19/09	4:05pm	30 Mins	98'8"	1.5			
7/19/09	4:35pm	30 Mins	98'8"	1.5			
7/19/09	5:05pm	30 Mins	98'8"	1.4	Flow Adjusted		
7/19/09	5:35pm	30 Mins	98'8"	1.4			
7/19/09	6:05pm	30 Mins	98'8"	1.4			
7/19/09	6:35pm	30 Mins	98'8"	1.4			
7/19/09	7:05pm	30 Mins	98'8"	1.4			
7/19/09	7:35pm	30 Mins	98'8"	1.4			
7/19/09	8:05pm	30 Mins	98'8"	1.4			
7/19/09	8:35pm	30 Mins	98'8"	1.4			
7/19/09	9:20pm		98'8"	1.4		End	12 Hr Test
7/22/09	5:00pm	72 Hrs. or	60'3"	-	Recovery		

Calculation of Well Recovery

(Worksheet example taken from PRMD No. 9-2-28)

1. Determine the water level draw down by subtracting the initial static water level measurement from the stabilized pumping level. Record this result as the well draw down.
2. Next determine the water level recovery by subtracting the post test (within 72 hours) static water level from the stabilized dynamic pumping level. Record this result as the well recovery.
3. Next determine the percent recovery of the well. Divide the water level recovery by the water level draw down and multiply by 100. Record this result as the percent well recovery.

Example:

a.	Initial static water level:	<u>58'7"</u>	(measured value)
b.	*Post test static water level:	<u>60'3"</u>	(measured value)
b.1.	Time (hours) of measurement:	<u>67hrs 40min</u>	(within 72 hours)
c.	**Stabilized pumping level:	<u>98'8"</u>	(measured value)
d.	Draw down:	<u>40'1"</u>	(calculate by subtracting A from C)
e.	Recovery:	<u>38'5"</u>	(calculate by subtracting B from C)
f.	Percent recovery:	<u>95.84%</u>	(calculate by dividing E by D and multiplying result by 100)

Well percent recovery (F) must be 90% or greater within a 72 hour period.

* The static water level after 72 hours or less post pump test.

** Kleinfelder refers to this as the dynamic pumping level.

PLOT MAP - 1880 HWY 1, BODEGA BAY

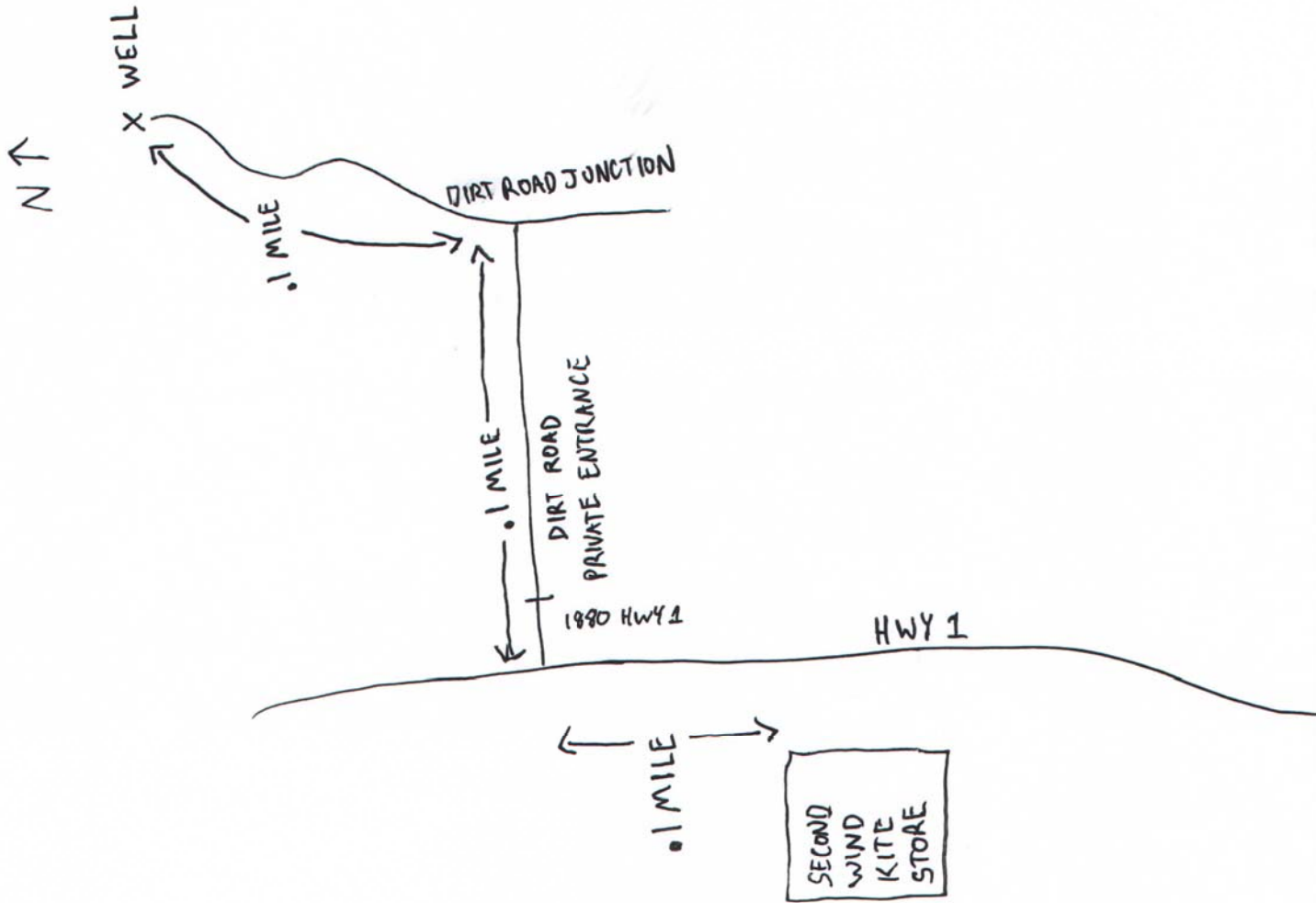

WELL COMPLETION REPORT

OWNER'S WELL No. 6836

Date Work Began 7/9/09 Ended 7/9/09

Local Permit Agency SONOMA

Permit No. WEL08-0248 Permit Date 7-16-2008

DWR USE ONLY -- DO NOT FILL IN

STATE WELL NO. STATION NO.											
LATITUDE						LONGITUDE					
APN / TRS / OTHER											

GEOLOGIC LOG

DEPTH FROM SURFACE Ft.	DEPTH TO FIRST WATER Ft.	DEPTH TO FIRST WATER (ft.) BELOW SURFACE	DESCRIPTION
0	10		brown clay with weathered sandstone
10	90		sandstone
90	100		shale
100	110		large broken up pieces of sandstone
110	160		sandstone
160	220		sandstone and shale
220	240		sandstone
240	260		sandstone and shale

WELL OWNER: NICK MAKRIS

Address 5889 SIERRA GRANDE BODEGA BAY CA 94923

Address 1880 HWY 1

City BODEGA BAY County SONOMA

Apn Book 100 Page 210 Parcel 057

Township or Range Section 1/4 1/4

Latitude or NORTH Longitude WEST
Deg. Min. Sec. Deg. Min. Sec.

LOCATION SKETCH

TOTAL DEPTH OF BORING 260 (Feet)

TOTAL DEPTH OF COMPLETED WELL 240 (Feet)

ACTIVITY NEW WELL PLANNED USE(S) DOMESTIC WATER

DRILLING METHOD ROTARY AIR FLUID

DEPTH OF STATIC WATER LEVEL 100 (Ft.) & DATE MEASURED Jul 9, 2009

ESTIMATED YIELD * (G.P.M.) & TEST TYPE ATRIEFT

TEST LENGTH. 2 (Hrs.) TOTAL DRAWDOWN 200 (FT.)

*May not be representative of a well's long-term yield.

DEPTH FROM SURFACE		BORE-HOLE DIA.	TYPE	CASING			DEPTH FROM SURFACE		ANNULAR MATERIAL	
Ft.	To Ft.			Material / Grade	Dia.	Gauge	Slot size	Ft.	To Ft.	Seal Material
0	60	10	Blank	F480 PVC	5	200	0	20	BENTONITE	
60	235	7 3/4	Perfs	F480 PVC	5	200	20	240		1/4 X 1/8
235	240	7 3/4	Blank	F480 PVC	5	200				

- Attachments**
- Geologic Log
 - Well Construction Diagram
 - Geophysical Logs
 - Soil Water Chemical Analyses
 - Other

CERTIFICATION STATEMENT

I, the undersigned, certify that this report is complete and accurate to the best of my knowledge and belief.

NAME ETSCH BROS DRILLING INC

(PERSON, FIRM, OR CORPORATION) (TYPED OR PRINTED)

5001 Gravenstein Hwy No Sebastopol CA 95472

Signed Steve Unterseher Steve Unterseher 071009 399226

WELL DRILLER / AUTHORIZED REPRESENTATIVE DATE SIGNED C- 57 LICENSE NUMBER